

Type HCSS

Hot and Cold Temperature
316 Stainless steel conduit
Liquid-Tight Flexible Metal Conduit (LFMC)



Construction

- Constructed of continuously interlocked 316 stainless steel core for exceptional crush and corrosion resistance.
- Durable, sunlight resistant thermoplastic PVC jacket that resists heat, oil and chemical breakdown.

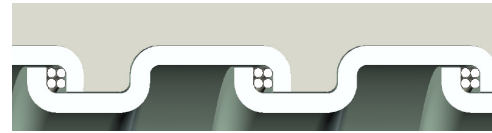

Square-Locked Design with cord packing 3/8" through 1-1/4"

Installation

- Conduit used with standard liquid-tight fitting for easy installation. IP 66/67 Rated when installed with approved fittings.
- Delivers superior wiring protection where agency approvals are not required.
- Manufactured in a full range of trade sizes from 3/8" through 2".
- Smooth appearing jacket for exposed applications.
- Rated for temperature range of -51°F to +221°F (-46°C to +105°C).
- Provides liquid-tight raceway for electrical conductors.



Interlocked Design 1-1/2" through 2"

www.naed.org

www.nema.org

www.anametelectrical.com

See pages 23-31 for fittings



• RoHS WEEE COMPLIANT

Type HCSS

Gray or Black thermoplastic PVC jacket no bonding wire



Product Specifications

Ordering Information

Electrical Trade Size		Inside Diameter		Outside Diameter		Approx Inside Bend Radius	Approx Weight lbs.	Small Carton		Small Reels	
Inches	mm	Inches		Inches				Inches	PER 100 FT.	Length Feet	NAED PIN
3/8	12	.484	-.504	.690	-.710	2.0	21	100	47202	500	47208
1/2	16	.622	-.642	.822	-.840	2.5	25	100	47212	500	47214
3/4	21	.820	-.840	1.030	-1.050	3.0	39	100	47222	500	47228
1	27	1.041	-1.066	1.290	-1.315	4.0	51	100	47231	400	47238
1-1/4	35	1.380	-1.405	1.630	-1.660	4.5	66	50	47241	250	47248
1-1/2	41	1.575	-1.600	1.865	-1.900	5.5	104	50	47251	150	47254
2	53	2.020	-2.045	2.340	-2.375	7.0	136	50	47261	100	47268

NOTE: 1. Gray - specification above.
2. Black -Change third number in NAED code to "0". Available in small cartons and small reels only.
3. Sizes above 2" available on special order.
4. Other colors available upon request.

TYPICAL SPECIFICATION:

Conduit shall be Anaconda SEALTITE® Type HCSS. Conduit shall provide a flexible liquid-tight raceway for wiring and shall be constructed of continuously interlocked 316 stainless steel core with sunlight resistant PVC outer jacket. Type HC conduit shall be used for applications where agency approvals are not required. Conduit IP 66/67 rated when installed with approved end fittings.